

**NOTE :**

This plan represents an indicative, potential layout of the development but is subject to change. Amendments to this plan and the final subdivisional plan will be dealt with by the Planning and Development Act".

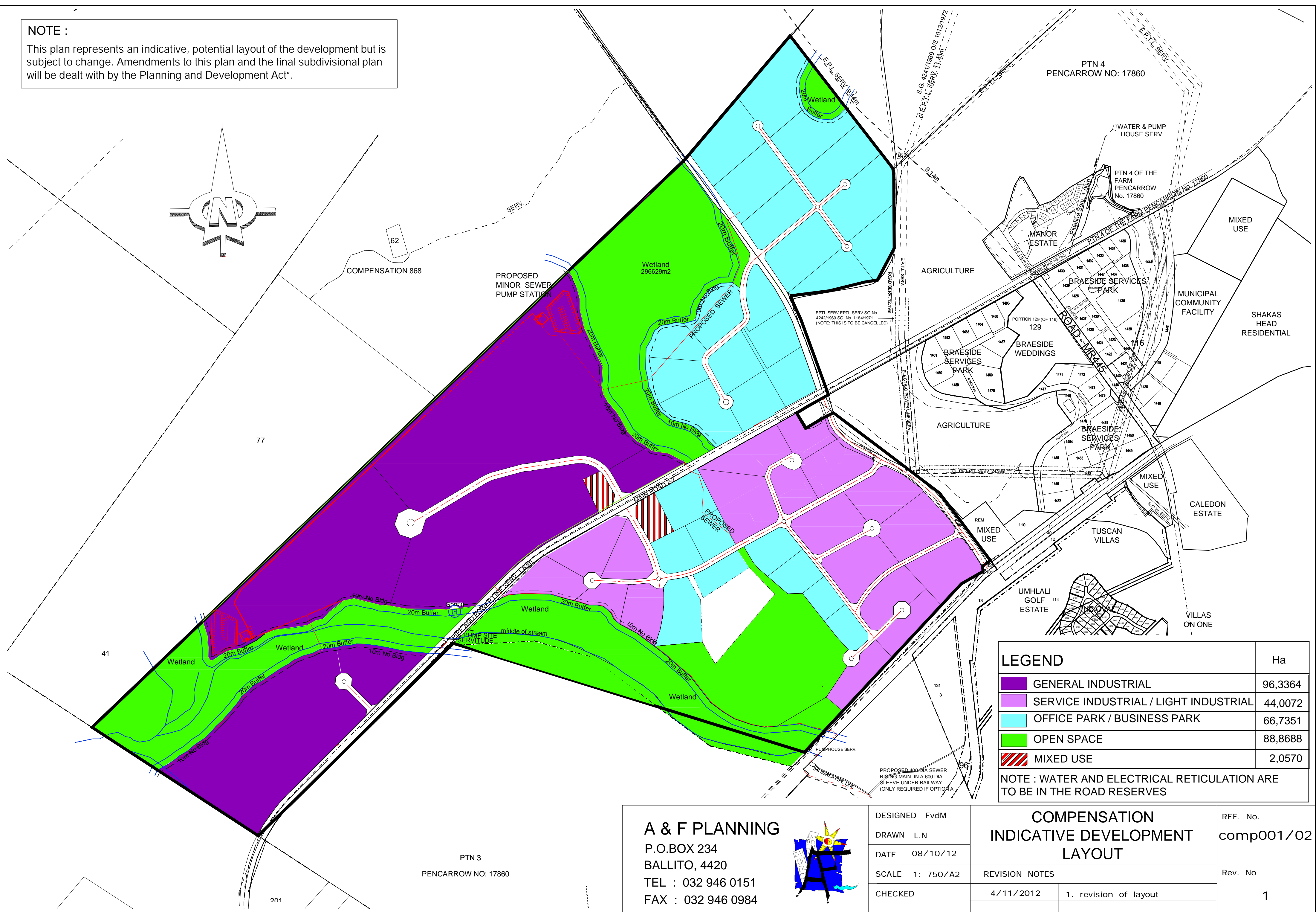
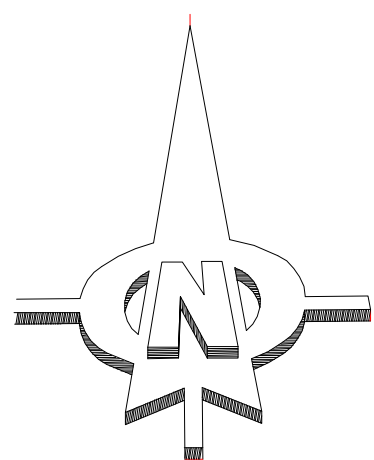

LEGEND		Ha
	GENERAL INDUSTRIAL	96,3364
	SERVICE INDUSTRIAL / LIGHT INDUSTRIAL	44,0072
	OFFICE PARK / BUSINESS PARK	66,7351
	OPEN SPACE	88,8688
	MIXED USE	2,0570

NOTE : WATER AND ELECTRICAL RETICULATION ARE TO BE IN THE ROAD RESERVES

**A & F PLANNING**  
 P.O.BOX 234  
 BALLITO, 4420  
 TEL : 032 946 0151  
 FAX : 032 946 0984

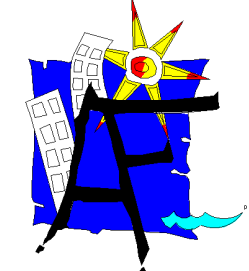

DESIGNED FvdM  
 DRAWN L.N  
 DATE 08/10/12  
 SCALE 1: 750/A2  
 CHECKED

**COMPENSATION INDICATIVE DEVELOPMENT LAYOUT**

REVISION NOTES		Rev. No
4/11/2012	1. revision of layout	1

REF. No.  
 comp001/02  
 Rev. No  
 1

PTN 3  
 PENCARROW NO: 17860

PTN 4  
 PENCARROW NO: 17860

WATER & PUMP HOUSE SERV

PTN 4 OF THE FARM PENCARROW No. 17860

EPTL SERV EPTL SERV SG No. 4242/1969 SG No. 1184/1971 (NOTE: THIS IS TO BE CANCELLED)

PROPOSED 400-DIA SEWER RISING MAIN IN A 600 DIA SLEEVE UNDER RAILWAY (ONLY REQUIRED IF OPTION A)

77

41

201

129

AGRICULTURE

AGRICULTURE

CALEDON ESTATE

VILLAS ON ONE

MIXED USE

MUNICIPAL COMMUNITY FACILITY

SHAKAS HEAD RESIDENTIAL

MIXED USE

PTN 4 OF THE FARM PENCARROW No. 17860

WATER & PUMP HOUSE SERV

PTN 4  
 PENCARROW NO: 17860

E.P.T.L. SERV.

E.P.T.L. SERV.

E.P.T.L. SERV.

E.P.T.L. SERV.

E.P.T.L. SERV.

E.P.T.L. SERV.

E.P.T.L. SERV.

E.P.T.L. SERV.

E.P.T.L. SERV.

E.P.T.L. SERV.

E.P.T.L. SERV.

E.P.T.L. SERV.

E.P.T.L. SERV.

E.P.T.L. SERV.

E.P.T.L. SERV.

E.P.T.L. SERV.

E.P.T.L. SERV.

E.P.T.L. SERV.